

# EMI BEADS (DIP) / RHWT TYPE

## FEATURES

- ◆ Employ high performance ferrites with superior frequency characteristics.

## APPLICATIONS

- ◆ Prevent spike noise
- ◆ Prevent intrusion and radiation of unnecessary signals into the clock pulse oscillation section and various interfaces, except those for RGB and composite signals.



## ORDERING CODE

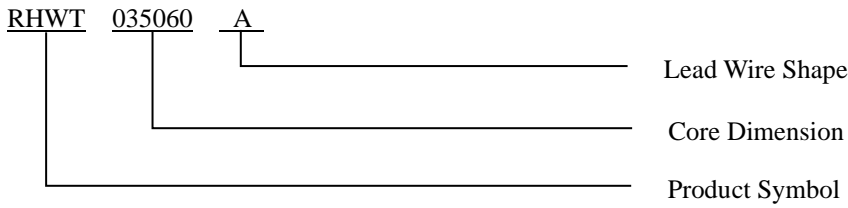

## LEAD WIRE SHAPE & TAPING SHAPE (UNIT: mm)

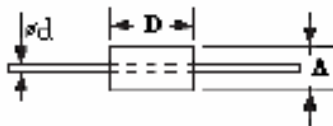

Fig. A

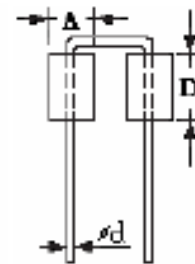
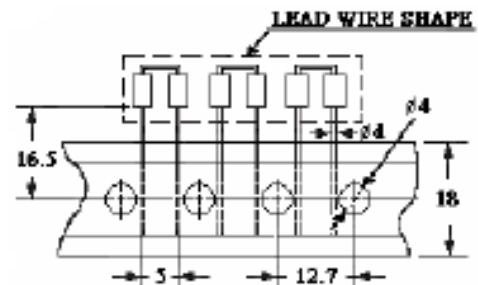
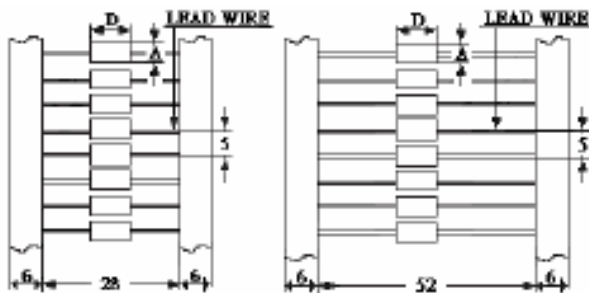

Fig. B



CORE MASTER ENTERPRISE CO., LTD.

<http://www.coremaster.com.tw>

## EMI BEADS (DIP) / RHWT TYPE

**DIMENSIONS (UNIT: mm)**

PartNo.	Fig.	A	D	Φd (±0.05)	Impedance (Ω) Min		
					25MHz	100MHz	
<b>RHWT 025030</b>	A	2.5 ±0.2	3.0 ±0.3	0.65	20	40	
<b>RHWT 025045</b>		2.5 ±0.2	4.5 ±0.3	0.65	30	50	
<b>RHWT 035030</b>		3.5 ±0.2	3.0 ±0.3	0.65	20	40	
<b>RHWT 035045</b>		3.5 ±0.2	4.5 ±0.3	0.65	35	60	
<b>RHWT 035050</b>		3.5 ±0.2	5.0 ±0.3	0.65	35	60	
<b>RHWT 035060</b>		3.5 ±0.2	6.0 ±0.3	0.65	40	70	
<b>RHWT 035080</b>		3.5 ±0.2	8.0 ±0.3	0.65	45	70	
<b>RHWT 035090</b>		3.5 ±0.2	9.0 ±0.3	0.65	55	90	
<b>RHWT 035045X2</b>		B	3.5 ±0.2	4.5 ±0.3	0.65	60	90
<b>RHWT 035050X2</b>			3.5 ±0.2	5.0 ±0.3	0.65	65	110
<b>RHWT 035060X2</b>	3.5 ±0.2		6.0 ±0.3	0.65	70	130	



**CORE MASTER ENTERPRISE CO., LTD.**

<http://www.coremaster.com.tw>

# FLAT CABLE EMI CORES / FP TYPE

## APPLICATIONS

- ◆ Internal floppy disk and harddisk ribbon cables
- ◆ Internal ribbon cables between circuit boards and data connectors
- ◆ Internal ribbon cables with series digital signal busses



## MATERIAL

B8 B10 B15

## ORDERING CODE

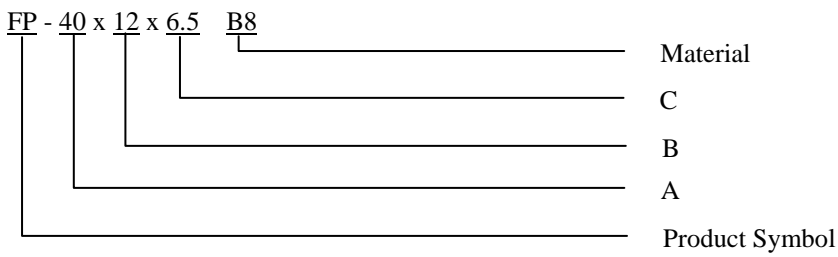

## SHAPES

Fig.1

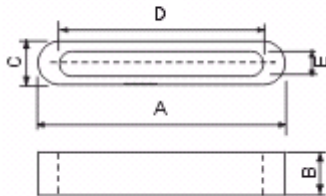
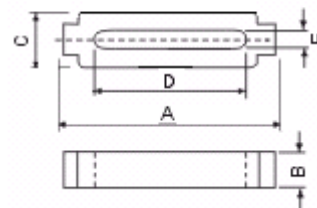

Fig.2



**CORE MASTER ENTERPRISE CO., LTD.**

<http://www.coremaster.com.tw>



## FLAT CABLE EMI CORES / FP TYPE

**DIMENSIONS (UNIT: mm)**

Part No.	Fig.	Dimension				
		A	B	C	D	E
FP-12X19X9	1	12.0 ± 0.3	19.0 ± 0.5	9.0 ± 0.3	7.5 ± 0.3	4.5 ± 0.3
FP-13.5X6X2	1	13.5 ± 0.3	6.0 ± 0.3	2.0 ± 0.3	11.0 ± 0.3	0.5+0.4-0
FP-16X8X5	1	16.0+0.2-0.5	8.0 ± 0.3	5.0+0-0.6	11.5+0.5-0.1	0.5+0.5-0
FP-18X8X5	1	18.0 ± 1.0	8.0 ± 0.5	5.0 ± 0.3	14.0 ± 0.5	1.0 ± 0.5
FP-19X6X6.5	1	19.0 ± 0.8	6.0 ± 0.5	6.5 ± 0.3	13.5 ± 0.6	1.5 ± 0.3
FP-19X12X6.5	1	19.0 ± 0.8	12.0 ± 0.5	6.5 ± 0.3	13.5 ± 0.6	1.5 ± 0.3
FP-23.8X12.5X6.3	1	23.8 ± 0.7	12.5 ± 0.5	6.3 ± 0.5	18.4 ± 0.5	1.1 ± 0.3
FP-23.8X12.5X6.5	1	23.8 ± 1.0	12.5 ± 0.6	6.5 ± 0.5	18.5 ± 0.7	1.5 ± 0.5
FP-25X12X5	1	25.0 ± 0.8	12.0 ± 0.5	5.0 ± 0.4	21.0 ± 0.7	1.2 ± 0.3
FP-28X10X7.7	2	28.0 ± 0.8	10.0 ± 0.4	7.7 ± 0.4	23.0 ± 0.5	1.4 ± 0.2
FP-28X14.6X7.7	2	28.0 ± 0.8	14.6 ± 0.4	7.7 ± 0.3	23.0 ± 0.5	1.4 ± 0.3
FP-29X10X8	1	29.0 ± 0.8	10.0 ± 0.5	8.0 ± 0.5	22.0 ± 0.8	2.5 ± 0.4
FP-31X12X5	1	31.0 ± 0.8	12.0 ± 0.5	5.0 ± 0.3	27.0 ± 0.8	0.5+0.7-0.1
FP-33.5X12X6.5	1	33.5 ± 1.0	12.0 ± 0.5	6.5 ± 0.5	27.5 ± 1.0	1.5 ± 0.5
FP-40X12X6.5	1	40.0 ± 1.2	12.0 ± 0.5	6.5 ± 0.3	33.5 ± 1.5	1.5 ± 0.3
FP-41X15X7.7	1	41.0 ± 1.2	15.0 ± 0.4	7.7 ± 0.4	34.5 ± 1.2	1.8 ± 0.4
FP-49.6X12X6.5	1	49.6 ± 1.5	12.0 ± 0.4	6.5 ± 0.5	43.0 ± 1.0	1.5 ± 0.5
FP-57.9X12X7	1	57.9 ± 0.7	12.0 ± 0.3	7.0 ± 0.3	52.0 +1.0-0.2	1.3 + 0.6-0

**CORE MASTER ENTERPRISE CO., LTD.**



<http://www.coremaster.com.tw>

# NI-ZN EMI BEAD CORES / RH TYPE

## FEATURES

- ◆ Easy installation
- ◆ Compact and high performance



## APPLICATIONS

- ◆ Countermeasures against radiated emissions
- ◆ For full compliance with FCC regulations and VCCI
- ◆ Improvement of noise immunity of personal computers, microcomputers, peripheral and relative devices

## MATERIAL

B8    B10    B15    B18

## ORDERING CODE

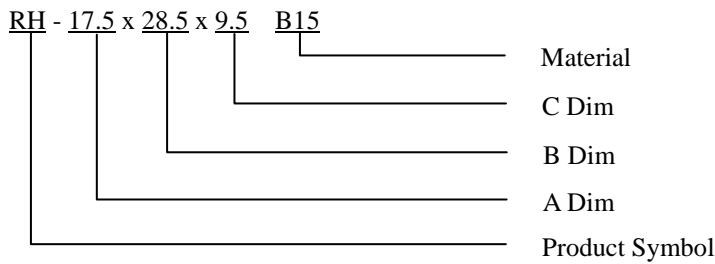

## SHAPES

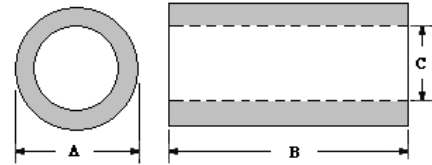

## DIMENSIONS (Unit: mm)

Cores	A	B	C
RH-2.3 x 4.5 x 0.8	2.30 ± 0.15	4.50 ± 0.30	0.80 ± 0.15
RH-3 x 3 x 0.8	3.00 ± 0.15	3.00 ± 0.20	0.80 ± 0.15
RH-3 x 4 x 1	3.00 ± 0.15	4.00 ± 0.30	1.00 ± 0.15
RH-3.5 x 8.9 x 0.8	3.50 ± 0.15	8.90 ± 0.30	0.80 ± 0.15
RH-3.5 x 12 x 1.2	3.50 ± 0.15	12.00 ± 0.40	1.20 ± 0.15
RH-3.5 x 10 x 1.5	3.50 ± 0.15	10.00 ± 0.40	1.50 ± 0.15
RH-3.5 x 13.8 x 0.8	3.50 ± 0.15	13.80 ± 0.40	0.80 ± 0.15
RH-3.8 x 8 x 1.8	3.80 ± 0.15	8.00 ± 0.40	1.80 ± 0.15
RH-4 x 5 x 2	4.00 ± 0.20	5.00 ± 0.30	2.00 ± 0.15
RH-4 x 20 x 2	4.00 ± 0.20	20.00 ± 0.50	2.00 ± 0.15
RH-4.1 x 10 x 1.6	4.10 ± 0.20	10.00 ± 0.40	1.60 ± 0.15
RH-5 x 10 x 1.5	5.00 ± 0.30	10.00 ± 0.40	1.50 ± 0.15
RH-6 x 10 x 3	6.00 ± 0.30	10.00 ± 0.40	3.00 ± 0.20
RH-6.5 x 10 x 4.3	6.50 ± 0.30	10.00 ± 0.40	4.30 ± 0.20
RH-7 x 20 x 4	7.00 ± 0.30	20.00 ± 0.50	4.00 ± 0.25
RH-7.5 x 19 x 2.8	7.50 ± 0.30	19.00 ± 0.50	2.80 ± 0.20
RH-7.75 x 19 x 4	7.75 ± 0.30	19.00 ± 0.50	4.00 ± 0.25
RH-8 x 18 x 3	8.00 ± 0.30	18.00 ± 0.50	3.00 ± 0.20
RH-8 x 9.2 x 4	8.00 ± 0.30	9.20 ± 0.30	4.00 ± 0.25
RH-8 x 20 x 5.6	8.00 ± 0.30	20.00 ± 0.60	5.60 ± 0.25
RH-9 x 16 x 5	9.00 ± 0.30	16.00 ± 0.50	5.00 ± 0.25
RH-9.5 x 18.2 x 2.8	9.50 ± 0.30	18.20 ± 0.50	2.80 ± 0.20
RH-9.5 x 10 x 5	9.50 ± 0.30	10.00 ± 0.40	5.00 ± 0.25
RH-9.8 x 14 x 5.6	9.80 ± 0.30	14.00 ± 0.50	5.60 ± 0.25
RH-9.8 x 25 x 7	9.80 ± 0.30	25.00 ± 0.70	7.00 ± 0.30

**CORE MASTER ENTERPRISE CO., LTD.**



<http://www.coremaster.com.tw>

## NI-ZN EMI BEAD CORES / RH TYPE

**DIMENSIONS (Unit: mm)**

Cores	A	B	C
RH-10 x 10 x 5	10.00 ± 0.40	10.00 ± 0.40	5.00 ± 0.25
RH-10.5 x 20 x 5.6	10.50 ± 0.40	20.00 ± 0.60	5.60 ± 0.25
RH-10.5 x 20 x 6	10.50 ± 0.40	20.00 ± 0.60	6.00 ± 0.30
RH-11.5 x 18 x 5.2	11.50 ± 0.40	18.00 ± 0.50	5.20 ± 0.25
RH-11.5 x 25 x 7.1	11.50 ± 0.40	25.00 ± 0.70	7.10 ± 0.30
RH-12 x 25 x 4	12.00 ± 0.40	25.00 ± 0.70	4.00 ± 0.25
RH-12 x 25.6 x 5.2	12.00 ± 0.40	25.60 ± 0.70	5.20 ± 0.25
RH-12 x 20 x 6.35	12.00 ± 0.40	20.00 ± 0.60	6.35 ± 0.30
RH-12 x 25 x 7.1	12.00 ± 0.40	25.00 ± 0.70	7.10 ± 0.30
RH-12 x 28 x 7.3	12.00 ± 0.40	28.00 ± 0.70	7.30 ± 0.30
RH-12.5 x 20 x 4.9	12.50 ± 0.40	20.00 ± 0.60	4.90 ± 0.30
RH-12.7 x 15 x 7.88	12.70 ± 0.40	15.00 ± 0.50	7.88 ± 0.30
RH-13 x 15.2 x 5.5	13.00 ± 0.40	15.20 ± 0.50	5.50 ± 0.25
RH-13 x 26 x 5.6	13.00 ± 0.40	26.00 ± 0.70	5.60 ± 0.30
RH-13 x 25.4 x 9.4	13.00 ± 0.40	25.40 ± 0.70	9.40 ± 0.30
RH-14 x 28.5 x 5.2	14.00 ± 0.50	28.50 ± 0.70	5.20 ± 0.25
RH-14.27 x 23.5 x 6.35	14.27 ± 0.50	23.50 ± 0.60	6.35 ± 0.30
RH-14.27x 28.5 x 6.35	14.27 ± 0.50	28.50 ± 0.70	6.35 ± 0.30
RH-14.27 x 15 x 7	14.27 ± 0.50	15.00 ± 0.50	7.00 ± 0.30
RH-14.27 x 28 x 7	14.27 ± 0.50	28.00 ± 0.70	7.00 ± 0.30
RH-14.27 x 23.5 x 7.88	14.27 ± 0.50	23.50 ± 0.60	7.88 ± 0.30
RH-14.27 x 23.5 x 8.3	14.27 ± 0.50	23.50 ± 0.60	8.30 ± 0.30
RH-14.27 x 28.5 x 9.15	14.27 ± 0.50	28.50 ± 0.70	9.15 ± 0.30
RH-15 x 28.5 x 7.3	15.00 ± 0.50	28.50 ± 0.70	7.30 ± 0.30
RH-15.25 x 28.5 x 8	15.25 ± 0.50	28.50 ± 0.70	8.00 ± 0.30
RH-15.8 x 28.5 x 7.88	15.80 ± 0.50	28.50 ± 0.70	7.88 ± 0.30
RH-16 x 17 x 4.5	16.00 ± 0.50	17.00 ± 0.50	4.50 ± 0.25
RH-16 x 16 x 7.88	16.00 ± 0.50	16.00 ± 0.50	7.88 ± 0.30
RH-16 x 17 x 9.15	16.00 ± 0.50	17.00 ± 0.50	9.15 ± 0.30
RH-16 x 30 x 9.15	16.00 ± 0.50	30.00 ± 1.00	9.15 ± 0.30
RH-16 x 28.5 x 9.5	16.00 ± 0.50	28.50 ± 1.00	9.50 ± 0.30
RH-16 x 28 x 11	16.00 ± 0.50	28.00 ± 0.70	11.00 ± 0.40
RH-17 x 25 x 4	17.00 ± 0.50	25.00 ± 0.70	4.00 ± 0.30
RH-17.2 x 25 x 7	17.20 ± 0.50	25.00 ± 0.70	7.00 ± 0.30
RH-17.5 x 27 x 8	17.50 ± 0.50	27.00 ± 0.70	8.00 ± 0.30
RH-17.5 x 28.5 x 8	17.50 ± 0.50	28.50 ± 0.70	8.00 ± 0.30
RH-17.5 x 28.5 x 9.5	17.50 ± 0.50	28.50 ± 0.70	9.50 ± 0.30
RH-17.5 x 35 x 9.5	17.50 ± 0.50	35.00 ± 1.00	9.50 ± 0.30
RH-17.5 x 28.5 x 10.6	17.50 ± 0.50	28.50 ± 0.70	10.60 ± 0.40
RH-17.5 x 28.5 x 11	17.50 ± 0.50	28.50 ± 0.70	11.00 ± 0.40
RH-18.2 x 28.5 x 9.5	18.20 ± 0.50	28.50 ± 0.70	9.50 ± 0.30
RH-18.4 x 28.5 x 10.2	18.40 ± 0.50	28.50 ± 0.70	10.20 ± 0.40
RH-18.4 x 50.8 x 11	18.40 ± 0.50	50.80 ± 1.00	11.00 ± 0.40
RH-18.4 x 28.5 x 12.5	18.40 ± 0.50	28.50 ± 0.70	12.50 ± 0.40
RH-19.7 x 28.5 x 11.7	19.70 ± 0.50	28.50 ± 0.70	11.70 ± 0.40
RH-25.9 x 28 x 10.2	25.90 ± 0.60	28.00 ± 0.70	10.20 ± 0.40
RH-26 x 28.5 x 12.8	26.00 ± 0.60	28.50 ± 0.70	12.80 ± 0.50
RH-26 x 28.5 x 16	26.00 ± 0.60	28.50 ± 0.70	16.00 ± 0.50
RH-28 x 28.5 x 16	28.00 ± 0.70	28.50 ± 0.70	16.00 ± 0.50

**CORE MASTER ENTERPRISE CO., LTD.**



<http://www.coremaster.com.tw>

## NI-ZN TOROID CORES / T TYPE

### FEATURES

- ◆ Minimal effect on transmission waveforms
- ◆ Can be added as First-Aid, On-The Spot countermeasures when equipment or devices fail



### APPLICATIONS

- ◆ Equipment using sensors
- ◆ TVs, FM/AM Tuners, VTRs/VCRs
- ◆ Harness noise countermeasures for automobiles Computers, NC machines, and Plain paper copiers
- ◆ Measuring equipment, OA equipment, terminal equipment and ISDN terminal equipment

### MATERIAL

B8 B10 B12 B15

### ORDERING CODE

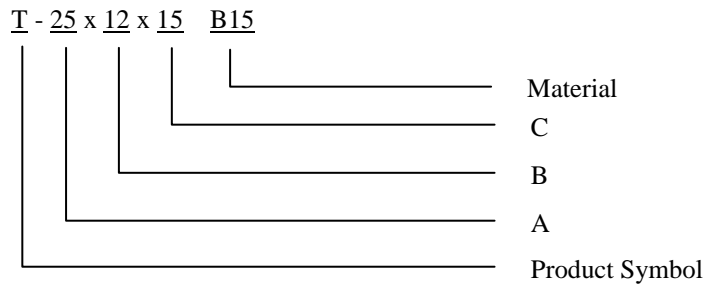

### SHAPES

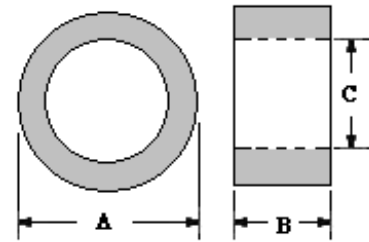

### DIMENSIONS (Unit: mm)

Cores	A	B	C
T-2.5 x 1.2 x 1	2.50 ± 0.15	1.20 ± 0.20	1.00 ± 0.15
T-3.3 x 2 x 2.58	3.30 ± 0.15	2.00 ± 0.25	2.58 ± 0.15
T-3.5 x 2 x 0.85	3.50 ± 0.15	2.00 ± 0.20	0.85 ± 0.15
T-3.5 x 3.1 x 1.2	3.50 ± 0.15	3.10 ± 0.30	1.20 ± 0.15
T-4 x 1 x 2	4.00 ± 0.20	1.00 ± 0.20	2.00 ± 0.20
T-4.5 x 2 x 1.5	4.50 ± 0.20	2.00 ± 0.20	1.50 ± 0.15
T-4.8 x 3 x 2.8	4.80 ± 0.20	3.00 ± 0.30	2.80 ± 0.20
T-6 x 4 x 3	6.00 ± 0.30	4.00 ± 0.30	3.00 ± 0.20
T-6 x 5 x 2	6.00 ± 0.30	5.00 ± 0.30	2.00 ± 0.20
T-6.5 x 5 x 3.3	6.50 ± 0.30	5.00 ± 0.30	3.30 ± 0.20
T-7.75 x 3 x 4	7.75 ± 0.30	3.00 ± 0.30	4.00 ± 0.20
T-8 x 3 x 4	8.00 ± 0.30	3.00 ± 0.30	4.00 ± 0.20
T-8 x 7 x 5.6	8.00 ± 0.30	7.00 ± 0.30	5.60 ± 0.20
T-9 x 3 x 5	9.00 ± 0.30	3.00 ± 0.30	5.00 ± 0.30
T-9.5 x 3.5 x 4.8	9.50 ± 0.30	3.50 ± 0.30	4.80 ± 0.20
T-9.66 x 3.7 x 4.9	9.66 ± 0.30	3.70 ± 0.30	4.90 ± 0.30
T-9.66 x 7.35 x 6.35	9.66 ± 0.30	7.35 ± 0.30	6.35 ± 0.30
T-9.8 x 7.35 x 6.35	9.80 ± 0.30	7.35 ± 0.30	6.35 ± 0.30

## NI-ZN TOROID CORES / T TYPE

Cores	A	B	C
<b>T-10 x 6 x 4</b>	10.00 ± 0.30	6.00 ± 0.30	4.00 ± 0.20
<b>T-10 x 4 x 6</b>	10.00 ± 0.30	4.00 ± 0.30	6.00 ± 0.30
<b>T-10 x 10 x 5</b>	10.00 ± 0.30	10.0 ± 0.40	5.00 ± 0.30
<b>T-10.3 x 10.2 x 5.8</b>	10.30 ± 0.30	10.2 ± 0.40	5.80 ± 0.30
<b>T-12 x 6 x 4</b>	12.00 ± 0.40	6.00 ± 0.30	4.00 ± 0.20
<b>T-12 x 4 x 6</b>	12.00 ± 0.40	4.00 ± 0.30	6.00 ± 0.30
<b>T-12 x 10 x 6.5</b>	12.00 ± 0.40	10.0 ± 0.40	6.50 ± 0.30
<b>T-12 x 11 x 8.6</b>	12.00 ± 0.40	11.0 ± 0.40	8.60 ± 0.30
<b>T-12.7 x 6.35 x 7.9</b>	12.70 ± 0.40	6.35 ± 0.40	7.90 ± 0.30
<b>T-12.7 x 12.5 x 7.88</b>	12.70 ± 0.40	12.5 ± 0.40	7.88 ± 0.30
<b>T-13 x 8 x 8.2</b>	13.00 ± 0.40	8.00 ± 0.30	8.20 ± 0.30
<b>T-13.5 x 5 x 7</b>	13.50 ± 0.40	5.00 ± 0.30	7.00 ± 0.30
<b>T-14.2 x 5 x 6.35</b>	14.20 ± 0.50	5.00 ± 0.30	6.35 ± 0.30
<b>T-14.2 x 5 x 9.15</b>	14.20 ± 0.50	5.00 ± 0.30	9.15 ± 0.30
<b>T-14.2 x 10 x 7.45</b>	14.20 ± 0.50	10.0 ± 0.40	7.45 ± 0.30
<b>T-14.2 x 5 x 8.3</b>	14.27 ± 0.50	5.00 ± 0.30	8.30 ± 0.30
<b>T-14.2 x 13.5 x 6.35</b>	14.27 ± 0.50	13.5 ± 0.40	6.35 ± 0.30
<b>T-15.2 x 12.7 x 10.2</b>	15.20 ± 0.50	12.7 ± 0.40	10.2 ± 0.30
<b>T-16 x 12 x 8</b>	16.00 ± 0.50	12.0 ± 0.40	8.00 ± 0.30
<b>T-16 x 12 x 9.15</b>	16.00 ± 0.50	12.0 ± 0.40	9.15 ± 0.30
<b>T-16 x 10 x 8</b>	16.00 ± 0.50	10.0 ± 0.40	8.00 ± 0.30
<b>T-16 x 16 x 7.88</b>	16.00 ± 0.50	16.0 ± 0.50	7.88 ± 0.30
<b>T-17.5 x 6.8 x 10.6</b>	17.50 ± 0.50	6.80 ± 0.30	10.6 ± 0.30
<b>T-17.5 x 12.7 x 10.2</b>	17.50 ± 0.50	12.7 ± 0.40	10.2 ± 0.30
<b>T-18.4 x 9.5 x 12.5</b>	18.40 ± 0.50	9.50 ± 0.30	12.5 ± 0.40
<b>T-20 x 4 x 5.2</b>	20.00 ± 0.50	4.00 ± 0.30	5.20 ± 0.30
<b>T-20 x 10 x 10.2</b>	20.00 ± 0.50	10.0 ± 0.40	10.2 ± 0.30
<b>T-20 x 14.2 x 5.2</b>	20.00 ± 0.50	14.2 ± 0.40	5.20 ± 0.30
<b>T-21.2 x 6 x 12.7</b>	21.20 ± 0.50	6.00 ± 0.30	12.7 ± 0.40
<b>T-22.5 x 6 x 13.8</b>	22.50 ± 0.50	6.00 ± 0.30	13.8 ± 0.50
<b>T-23 x 6.4 x 12.5</b>	23.00 ± 0.50	6.40 ± 0.30	12.5 ± 0.40
<b>T-23 x 9.5 x 12.5</b>	23.00 ± 0.50	9.50 ± 0.30	12.5 ± 0.40
<b>T-23 x 14 x 11</b>	23.00 ± 0.50	14.0 ± 0.30	11.0 ± 0.40
<b>T-24 x 14 x 11</b>	24.00 ± 0.60	14.0 ± 0.40	11.0 ± 0.40
<b>T-25 x 10 x 15</b>	25.00 ± 0.60	10.0 ± 0.40	15.0 ± 0.50
<b>T-25.9 x 14.09 x 17</b>	25.90 ± 0.60	14.09 ± 0.40	17.0 ± 0.50
<b>T-25.9 x 12.7 x 16</b>	25.90 ± 0.60	12.7 ± 0.40	16.0 ± 0.50
<b>T-28 x 3.75 x 5.2</b>	28.00 ± 0.70	3.75 ± 0.30	5.20 ± 0.30
<b>T-28 x 13.4 x 16</b>	28.00 ± 0.70	13.40 ± 0.40	16.0 ± 0.50
<b>T-28 x 19 x 16</b>	28.00 ± 0.70	19.0 ± 0.50	16.0 ± 0.50
<b>T-29 x 14 x 19</b>	29.00 ± 0.70	14.0 ± 0.30	19.0 ± 0.50
<b>T-31 x 7 x 19</b>	31.00 ± 0.70	7.00 ± 0.30	19.0 ± 0.50
<b>T-31 x 16 x 19</b>	31.00 ± 0.70	16.0 ± 0.50	19.0 ± 0.50
<b>T-36 x 12 x 23</b>	36.00 ± 0.80	12.0 ± 0.40	23.0 ± 0.60
<b>T-36 x 22 x 19</b>	36.00 ± 0.80	22.0 ± 0.60	19.0 ± 0.50
<b>T-37.5 x 5.5 x 9.1</b>	37.50 ± 0.80	5.50 ± 0.30	9.10 ± 0.30
<b>T-40 x 15 x 23.4</b>	40.00 ± 0.80	15.0 ± 0.50	23.4 ± 0.60
<b>T-40.6 x 15 x 27.5</b>	40.60 ± 1.00	15.0 ± 0.40	27.5 ± 0.60
<b>T-61.4 x 12.8 x 36</b>	61.40 ± 1.30	12.8 ± 0.40	36.0 ± 0.80

**CORE MASTER ENTERPRISE CO., LTD.**



<http://www.coremaster.com.tw>



## ROUND CABLE EMI CORES / LF TYPE

### FEATURES

- ◆ Easy installation
- ◆ Internal dimensions are from 4mm to 19 mm diameter.
- ◆ The smooth surface prevents damage to wire insulation.



### APPLICATIONS

- ◆ Internal and external power cables
- ◆ Internal cables between pc boards and data connectors
- ◆ Computer peripherals, for example digital camera, DVD, fax machine, monitor, printer, and power supply cables

### ORDERING CODE

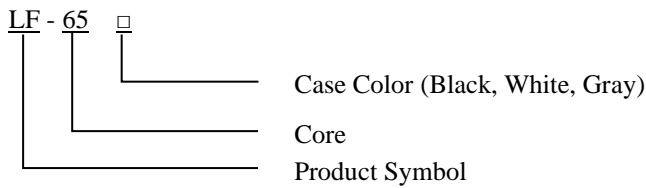

### SHAPES

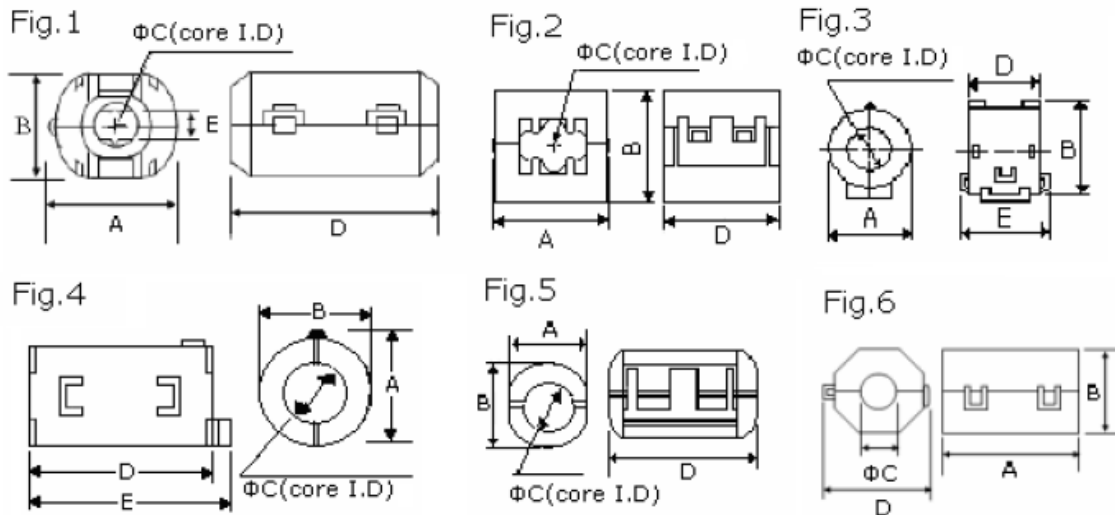

CORE MASTER ENTERPRISE CO., LTD.

<http://www.coremaster.com.tw>

## ROUND CABLE EMI CORES / LF TYPE

**DIMENSIONS (UNIT:mm)**

Part No.	Fig.	A (±1)	B (±1)	C (±1)	D (±1)	E (±1)	Impedance (Ω) Min		Use Cable OD
							25 MHz	100 MHz	
LF-35	5	15.0	15.0	4.0	25.2	---	55	95	Φ4
LF-50	5	16.5	16.5	5.2	29.5	---	50	100	Φ5
LF-501	2	15.0	14.0	5.2	23.0	---	65	135	Φ5
LF-502	1	13.0	11.8	5.0	25.5	---	60	120	Φ5
LF-503	1	16.5	15.0	5.2	30.0	---	108	184	Φ5
LF-60	6	18.5	14.0	6.0	15.5	---	40	70	Φ6
LF-65	2	20.5	20.0	6.5	33.0	---	105	195	Φ6.5
LF-70	4	15.5	14.0	7.0	18.0	22.0	35	75	Φ7
LF-702	1	17.0	15.0	7.0	30.0	---	65	120	Φ7
LF-75	5	21.0	21.0	7.5	39.0	---	80	150	Φ7.5
LF-801	3	19.5	23.0	8.1	17.0	23.0	50	100	Φ8
LF-802	3	19.5	23.0	8.1	20.0	26.0	50	100	Φ8
LF-901	4	20.5	19.5	9.0	31.5	35.5	90	210	Φ9
LF-902	1	19.5	18.0	9.0	35.0	---	80	160	Φ9
CT-0933	1	20.9	20.9	9.3	41.8	---	105	190	Φ9
CT-0933-2B	1	22.0	23.5	9.3	43.0	---	100	180	Φ9
LF-100	2	25.5	23.5	10.0	33.0	---	100	200	Φ10
LF-101	3	24.5	28.5	10.2	13.5	20.0	30	70	Φ10
LF-102	1	21.5	20.0	10.0	35.0	---	80	140	Φ10
LF-110	4	20.5	21.0	11.0	32.0	36.0	80	130	Φ11
LF-120	3	28.0	32.0	11.5	18.0	24.0	45	100	Φ11.5
LF-130	2	31.5	30.0	13.0	33.0	---	105	170	Φ13
LF-1301	1	23.5	22.5	13.0	36.0	---	60	130	Φ13
LF-1302	4	31.5	30.5	13.0	34.0	39.0	80	130	Φ13
LF-150	3	29.0	33.0	15.0	15.5	21.5	30	75	Φ15
LF-190	2	29.2	29.4	19.4	42.0	---	80	160	Φ19



**CORE MASTER ENTERPRISE CO., LTD.**

<http://www.coremaster.com.tw>

## SMD WIDE BAND CHOKES / MSH TYPE

### APPLICATIONS

The wide band choke cores are mainly used in the PC boards to filters the EMI from the outsides.



### ORDERING CODE

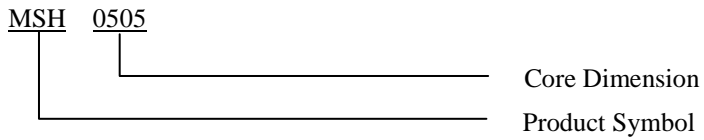

### SHAPES

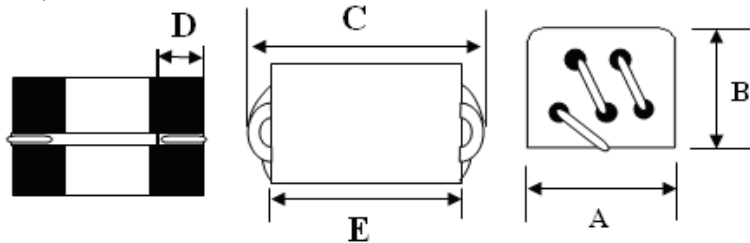

### DIMENSIONS & CHARACTERITICS (UNIT: mm)

Part No.	Impedance ( $\Omega$ ) (MIN)		A	B	C	D	E
	25 MHz	100 MHz					
MSH0505-02	128	280	$5.0 \pm 0.3$	$4.6 \pm 0.3$	8.0 Max	$1.5 \pm 0.5$	$5.5 \pm 0.3$
MSH0510-02	300	500	$5.0 \pm 0.3$	$4.6 \pm 0.3$	11.0 Max	$2.0 \pm 0.5$	$8.4 \pm 0.2$

CORE MASTER ENTERPRISE CO., LTD.

<http://www.coremaster.com.tw>



## SURFACE MOUNT BEADS / FB TYPE

### APPLICATIONS

Computer disk drive and PC Board to filter the EMI from Outside source, Car radio, Mobile phone and VCRS.



### ORDERING CODE

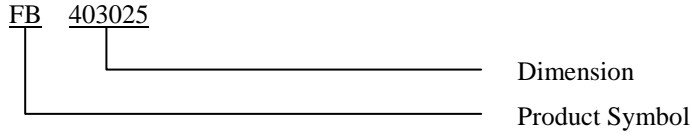

### SHAPES

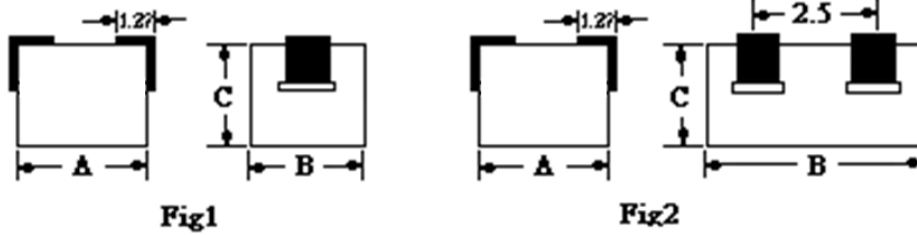

### DIMENSIONS (UNIT: mm)

Part No.	Fig.	A	B	C	Impedance ( $\Omega$ ) Min	
					25MHz	100MHz
FB 403025	1	$4.0 \pm 0.20$	$3.0 \pm 0.20$	$2.5 \pm 0.20$	25	35
FB 853025	1	$8.5 \pm 0.25$	$3.1 \pm 0.15$	$2.5 \pm 0.15$	60	90
F2B 455625	2	$4.5 \pm 0.25$	$5.6 \pm 0.20$	$2.5 \pm 0.20$	20	35
F2B 855625	2	$8.5 \pm 0.25$	$5.6 \pm 0.20$	$2.5 \pm 0.20$	48	70

## WIDE BAND CHOKE / R6H TYPE

### APPLICATIONS

- ◆ R6H Type Cores are used for Wide Band Choke. The impedance is substantially resistive and constant.
- ◆ Used in PC boards to filter the EMI from the outsides.
- ◆ For radio and TV, small motor ignition device, computer disk driver, communication equipment, and etc.



### ORDERING CODE

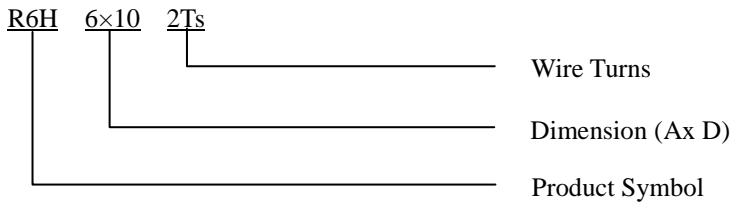

### SHAPES

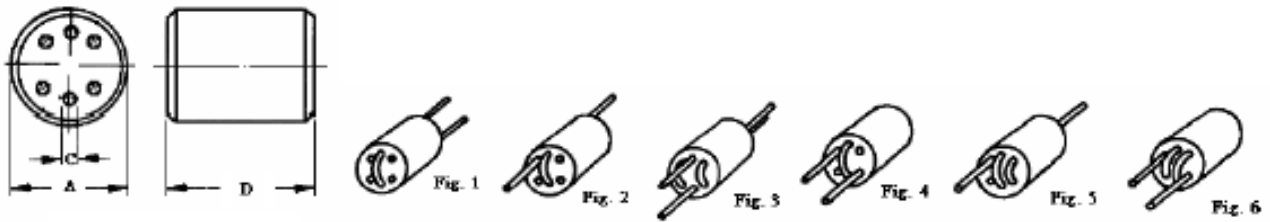

### DIMENSIONS & CHARACTERISTICS (UNIT: mm)

Part No.	Turns	Fig.	Impedance (Ω) (MIN)		A	C	D
			25 MHz	100 MHz			
R6H 6×10	1	1	140	320	6.0 ± 0.25	0.80 ± 0.15	10.0 ± 0.4
R6H 6×10	1.5	2	250	480	6.0 ± 0.25	0.80 ± 0.15	10.0 ± 0.4
R6H 6×10	2 x 1.5	3	300	480	6.0 ± 0.25	0.80 ± 0.15	10.0 ± 0.4
R6H 6×10	2	4	300	600	6.0 ± 0.25	0.80 ± 0.15	10.0 ± 0.4
R6H 6×10	2.5	5	350	640	6.0 ± 0.25	0.80 ± 0.15	10.0 ± 0.4
R6H 6×10	3	6	500	780	6.0 ± 0.25	0.80 ± 0.15	10.0 ± 0.4

**CORE MASTER ENTERPRISE CO., LTD.**



<http://www.coremaster.com.tw>